

PW140E Mechanical adjustable pressure switch

Principle structure

The controller adopts diaphragm type, corrugated pipe, piston and spring tube load sensing elements. The common type can be used to realize automatic pressure control in the places where the corrosive effect of the load sensing elements is odor, liquid or steam.

The explosion-proof mark of the explosion-proof product is Exed 11CT6, which can be used for the automatic pressure control of class 11a, 11B, 11C t1-t6 explosive gas mixtures in places where the pressure sensor has no corrosive effect on gas, liquid or steam.

The adjustment range of the set value of the controller is $-0.1 \sim 40\text{Mpa}$. The working pressure is 1.5 times of the range.

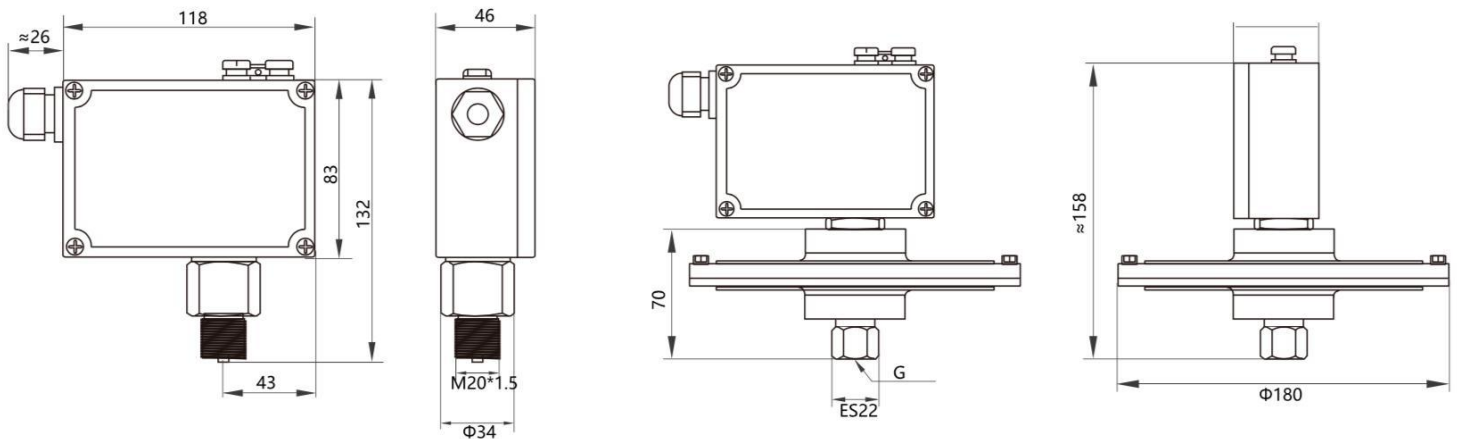
Size chart (mm)

Technical parameters

	Ordinary type	Explosion-proof type
Work viscosity	$\leq 10^{-3} \text{ m}^2/\text{S}$	$\leq 10^{-3} \text{ m}^2/\text{S}$
Switching element	Micro switch	Micro switch
Explosion-proof grade		EXed 11CT6
Enclosure protection class	IP65	IP65
Environment temperature	$-15^{\circ}\text{C} - 55^{\circ}\text{C}$	$-15^{\circ}\text{C} - 55^{\circ}\text{C}$
Environment humidity	5% - 95%	5% - 95%
Service life	10^5 cycle	10^5 cycle
Resistant	$< M a \times 2 \text{ g}$	$< M a \times 2 \text{ g}$
Rated load	$V \text{ m a x} = 380\text{VZ max} = 5 \text{ A}$	$V \text{ m a x} = 380 \text{ VZ max} = 5 \text{ A}$
Renaturation error	$\leq 1.0 \%$	$\leq 1.0 \%$

Range sheet

Range code	Range	differential gap	Switching frequency	Sensor material
KK06	0-6KPa	0.2KPa	10time/minute	Nitrile rubber
KK25	0-25KPa	0.5KPa		
KM016	0.006-0.16MPa	0.004MPa	20time/minute	316L
KM100	0.02-1.0MPa	0.25MPa	20time/minute	316L
KM025	0.05-0.25MPa	0.25MPa	20time/minute	316L
KM600	0.3-6MPa	0.3MPa	20time/minute	316L
KG10	1-10MPa	0.3MPa	20time/minute	316L
KG16	1-16MPa	0...5MPa	20time/minute	316L
KG25	2-25MPa	0.5MPa	20time/minute	316L
KG40	2-40MPa	1.5MPa	20time/minute	316L

Order guide

PW140E	KK06	E	G14K	M20K	0	L	detailed
PW140E	KK06	E	G14K G14M N14M G12K G12M N12M M20M F25 F50	M20K	0	L	Mechanical adjustable pressure switch
							explosion- proof
		No explosion- proof					
		Mounting thread : G1/4 internal thread					
		Mounting thread : G1/4 External thread					
		Mounting thread : NPT1/4 External thread					
		Mounting thread : G1/ 2 internal thread					
		Mounting thread : G1/ 2 External thread					
		Mounting thread : N1/ 2 External thread					
		Mounting thread : M20*1 .5 External thread					
		Flange installation : DN25					
		Flange installation : DN50					
		Cable gran					
		Electrical interface : M20*1 .5 internal thread					
	Electrical interface : G1/2 internal thread						
	Electrical interface : NPT1/2 internal thread						
		0	No display window				
		1	With display window				
		L	Medium temperature : < 80°C				
		H	Medium temperature : < 160°C				