

FMM501Dmass Series mass flowmeter / controller

- accuracy±1% F.S
- Linear analog output
- Preheating time, small zero drift, high reliability
- Digital signals can be controlled and displayed by computer.
- Flow range 0-300SLM

FMM501Dmass series is a analog digital compatible mode instrument, can be adjusted by analog digital display controller or instrument panel, or PLC to set and display instantaneous flow. This product applies MultiFlow technology, can be built in a variety of gas, can adapt to a variety of range. More efforts can be made to reduce the cost of purchasing.



application

- Gas flow measurement / control
- Medical equipment
- Glass industry
- Vacuum coating
- Analysis instrument
- fuel cell
- Atmospheric detection
- metallurgy
- environmental protection
- Gas preparation
- Solar energy

Product size diagram

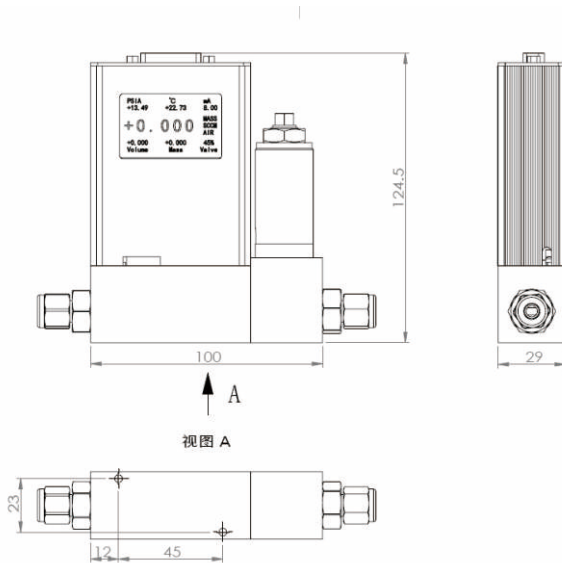

Dmass MFM&MFC Digital communication with Modbus

series	function	Sensor range	connect fitting	Gas name	User range	signal	display
FMM501D	FM: flow metr FC:flow controller	10: 10SCCM-20SLM 20: 30-100SLM 30: 100-200SLM 40: 200-300SLM	1/4 3/8 6mm 8mm 0: custom	N2	5SLM	A:0-5V B:4-20mA	01:with 02:without

Example selection:FMM501DFC10-1/4-N2-5SLM-A01

Specification sheet

Technical indicators	FMM501D-FC	FMM501D-FM
Range	2SCCM-200SLM	
Accuracy	±1% F.S	
linear	temperature ±1℃	
Repeatability	±0.5% F.S	
response time	0.2% F.S	< 1s
Analog	< 2s	
communication	0-5v/4-20mA	
power supply	RS485 Modbus RTU	
working temp	±15V/24V	
Working pressure	Dp: 0.05-1.0MPa	press drop: < 30Kpa
Max pressure	3Mpa/10Mpa	
Electrical connection	DB15	
Leakage rate	1×10 ⁻⁸ SCCSHe	
temp C.F	±0.015% F.S/℃	
Base material	316 SST	
sealing	PTFE/CR/NBR	
Fitting	1/4" 3/8" 6mm 10mm	

FMM501XDmass Series mass flowmeter / controller

- accuracy±1% F.S
- Linear analog output
- Preheating time, small zero drift, high reliability
- Digital signals can be controlled and displayed by computer.
- Flow range 0-300SLM

FMM501XDmass series is a analog digital compatible mode instrument, can be adjusted by analog digital display controller or instrument panel, or PLC to set and display instantaneous flow. This product applies MultiFlow technology, can be built in a variety of gas, can adapt to a variety of range. More efforts can be made to reduce the cost of purchasing.

application

- Gas flow measurement / control
- Medical equipment
- Glass industry
- Vacuum coating
- Analysis instrument
- fuel cell
- Atmospheric detection
- metallurgy
- environmental protection
- Gas preparation
- Solar energy

Product size diagram

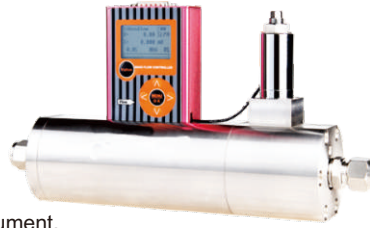
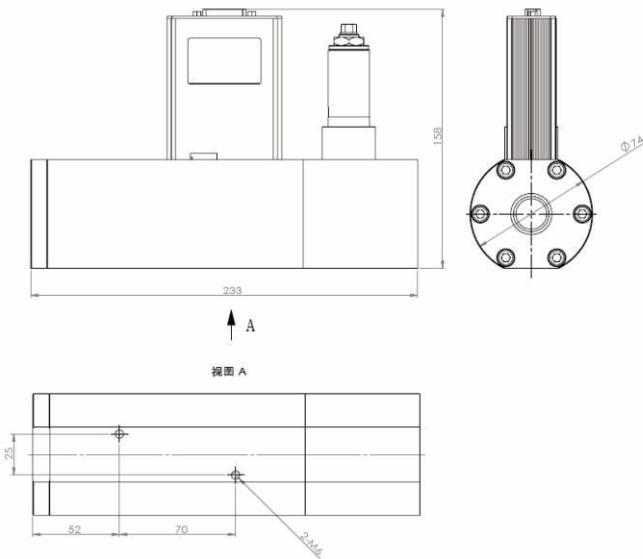

Specification sheet

Technical indicators	FMM501XD-FC	FMM501XD-FM
Range	300SLM-3000SLM	
Accuracy	±1% F.S	
	temperature ±1℃	
linear	±0.5% F.S	
Repeatability	0.2% F.S	
response time	< 2s	< 1s
Analog	0-5v/4-20mA	
communication	RS485 Modbus RTU	
power supply	±15V/24V	
working temp	0-50℃	
Working pressure	Dp: 0.05-1.0MPa	press drop < 30Kpa
Max pressure	3Mpa/10Mpa	
Electrical connection	DB15	
Leakage rate	1×10 ⁻⁸ SCCSHe	
temp C.F	±0.015% F.S/℃	
Base material	316 SST	
sealing	PTFE/CR/NBR	
Fitting	1/4" 3/8" 6mm 10mm	

series	function	Sensor range	connect fitting	Gas name	User range	signal	display
FMM501XD	FM: flow metr FC:flow controller	10: 300-500SLM 20: 1000-2000SLM 30: 2000-3000SLM	3/8 1/2 10mm 12mm 0: custom	N2	500SLM	A:0-5V B:4-20mA	01:with 02:without

Example selection:FMM501XD FC10-3/8-N2-500SLM-B02