

MPG Distant Transmission Mechanical Melt Pressure Gauges

FEATURES

- Pressure range:0~100bar or 0~1000bar
- Accuracy level:±1.6%F.S
- Special diaphragm coating
- IP65 protection level
- 4~20mA signal output available



OVERVIEW

MPG series high temperature melt pressure gauge series is designed to measure pressure at high temperature in the industries of injection molding and chemical fiber, special diaphragm and highly anti-abrasive coating of which enable it to work normally at high temperature of 400°C.It adopts standard threaded connection and is characterized by high stability and long service life.

SPECIFICATION

Pressure range	0~100Bar~2000bar (0~10Mpa~200Mpa)
Accuracy	±0.25% FS, ± 0.5% FS
Output	1.5mV/V, 2.0mV/V, 4~20mA, 0~5V, 0~10V
Input voltage	10VDC, 24VDC (12-36V)
Repeatability	± 0.1% FS
Overload pressure	1.5 X FS
Bridge impedance	350 Ohms ± 10%, 1000 Ohms ± 10%
Load resistance	500Ω @26VDC, 1000Ω @36VDC,
Internal self-calibration	80% FS ± 1%
Temperature component	PT100, E, J, K
Maximum diaphragm temperature	400 ° C
Diaphragm material	15-5PH, 17-4PH, Inconel718
Electrical connections	6 or 8 PIN Bendix connector
Process connection	1/2''-20UNF, M14×1.5, M18×1.5, M22×1.5 more customized

OUTLINE DIMENSION

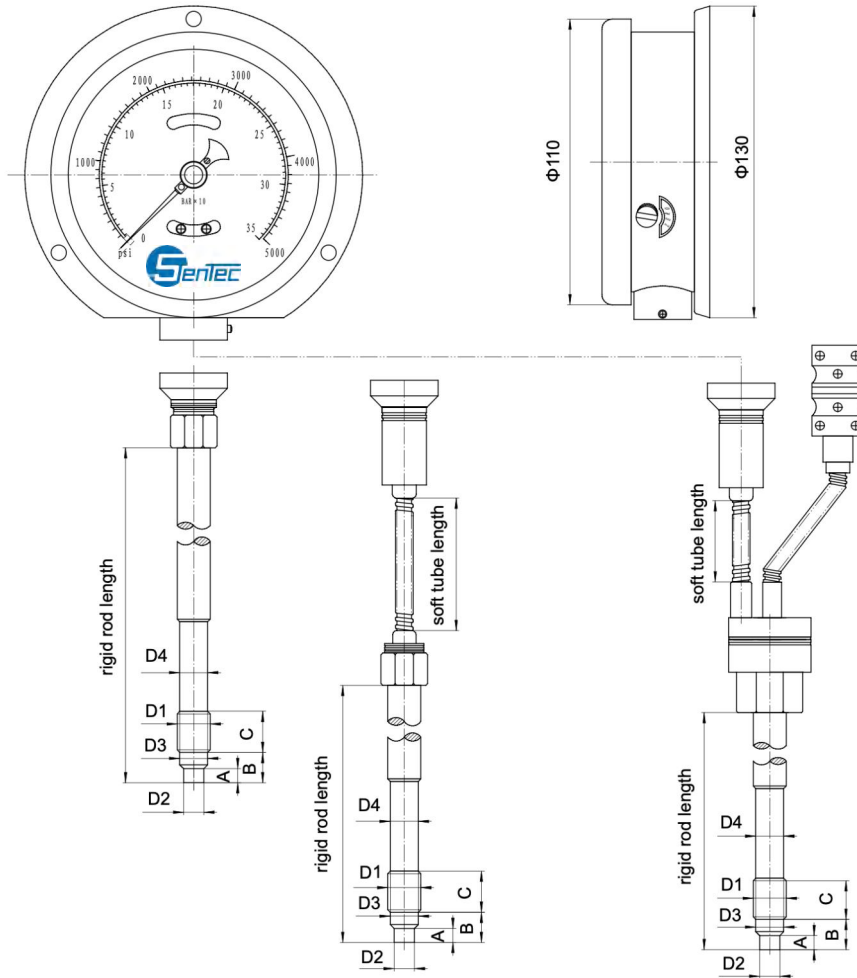

HOLE SIZE

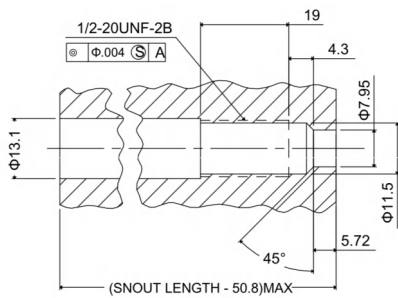

D1	D2	D3	D4	D5	A	B	C
1/2-20UNF	Φ7.8	Φ10.5	Φ10.5	Φ12.7	5.5	11.5	16
M14×1.5	Φ7.8	Φ11.5	Φ11.5	Φ12.7	5.5	11.5	16
M18×1.5	Φ9.8	Φ15.8	Φ12.7	Φ12.7	5.5	14.5	20

ELECTRIC CONNECTION

- MV/Volt Signal

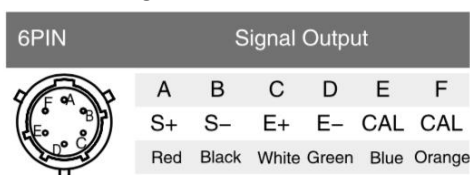

- MA Signal

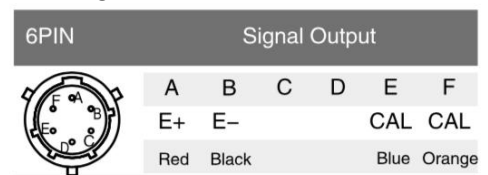

ORDER CODE

MPG	-	-	-	-	-	-	-	-	Parameters
Range	X M								1M=1000psi=70bar 1.5M=1500psi=100bar 3M=3000psi=200bar 5M=5000psi=350bar 7.5M=7500psi=500bar 10M=10000psi=700bar 15M=15000psi=1000bar 20M=20000psi=1400bar 30M=30000psi=2000bar
Accuracy	M								± 0.5% FSO
	H								± 0.25% FSO
Signal output		1MV							1MV=1.5mV/V
		2MV							2MV=2mV/V
		3MV							3MV=3.33mV/V
		MA							MA=4~20mA
		5V							5V=0~5V
		10V							10V=0~10V
Rigid stem length			3						3"=76mm
			6						6"=152mm
			9						9"=230mm
			12						12"=305mm
Flexible stem length			0						No Flex
			18						18"=460mm
			30						30"=762mm
Process connection				1/2					1/2-20UNF
				M14					M14*1.5
				M18					M18*1.5
Electrical connection					6				6 PIN
					8				8PIN
Temperature sensor						TC			E, J, K thermocouple with 3" Flex
						RTD			Pt100 with 3" Flex

SPARE PARTS

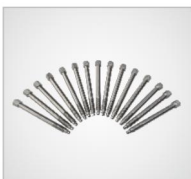

Rupture disk



Drilling kits



Cleaning kits



Mini deadweight tester