

SLS3500 Series skid armored level transmitter

MAIN FEATURES

- Armored structure for easy installation
- Liquid contact is all stainless steel, clean and hygienic
- Intrinsically safe explosion
- A variety of installation options are available



SPECIFICATION

ITEMS	PARAMETER
Range	0m~0.5m...10m
Overload capability	≤ 2 times full scale
Pressure Type	G (gauge pressure)
Accuracy	0.1% (custom), 0.25% (typical), 0.5% (maximum)
Long-term stability	±0.1%FS/year (typical), ±0.2%FS/year (maximum)
Zero temperature drift	±0.03%FS/°C, ±0.02%FS/°C
Sensitivity temperature drift	±0.03%FS/°C, ±0.02%FS/°C
Compensation temperature	0°C~50°C, -10°C~70°C
Working temperature	-40°C~80°C
Power supply	12~30VDC
Output Signal	4~20mA (superimposable HART protocol),0~10V (output range can be customized), RS485
Load Resistance	Current type: ≤ (U-12) / 0.02 (Ω)
Explosion-proof grade	Ex d IIC T5 Gb
Protection level	IP68

TYPICAL DIMENSION

Unit: mm

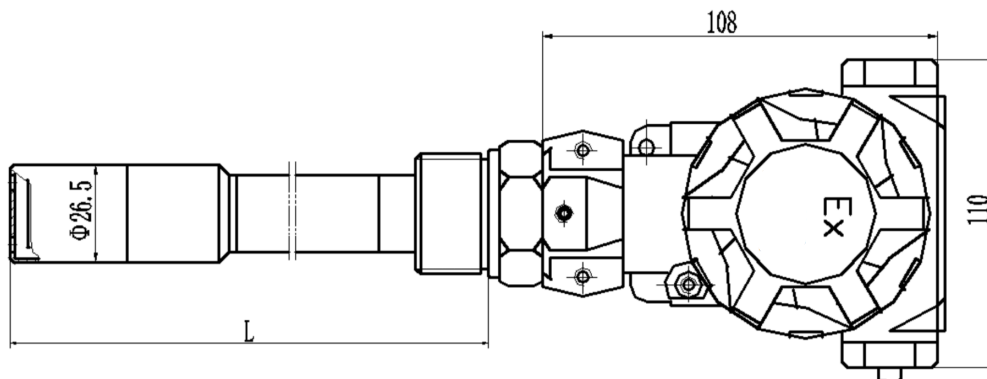

TYPES & FEATURES

MODEL	FEATURE	OUTLINE CONSTRUCTION
SLS3510	<ol style="list-style-type: none"> Standard BP11A junction box; M30×2 threaded interface; The wetted materials 304 and 316L are optional. 	
SLS3520	<ol style="list-style-type: none"> The depth of insertion is adjustable; The pressure sensitive film moves forward and is easy to clean; 304, 316L material can be customized. 	
SLS3530	<ol style="list-style-type: none"> Flexible armored structure of bellows; The wetted parts are all welded, safe and reliable; Can replace the SLS301 series of products, using high permeability liquid level measurement. 	

ELECTRIC CONNECTION

Current type	Voltage type	RS485 type

ORDER CODE

Code:	A	-	B	-	C	-	D	-	E	-	F
Model:	SLS3510	-	5m	-	S	-	S4	-	L5	-	MA

Model	Code A
Standard BP11A junction box type	3510
Insertion depth adjustable type	3520
Flexible armored structure type	3530
Level Range(X=specific range)	Code B
0m~0.5m...10m	X m
Accuracy	Code C
0.1% (custom)	C
0.25%(typical)	T
0.5%(standard)	S
Probe material	Code D
304	S4
316L	S6
Other customized	C

Sensor probe length	Code E
1m	L1
5m	L5
....	...
10m	L10
Output signal	Code F
4mA~20mA (superimposable HART protocol)	MA
0V~10V (output range can be customized)	V1
RS485	RS
More customized	C

Remarks:

1. Please indicate the appropriate measurement range and accuracy requirements when ordering. To ensure product stability and accuracy, it is recommended that the pressure transmitter range be selected based on 120% of the actual measured pressure range. The maximum pressure should be within the measurement range.
2. When ordering a transmitter with an LCD or LED meter, the power supply of the transmitter should be no less than 15VDC.
3. When selecting digital display products, the working temperature range of the transmitter is -30°C~70°C.
4. For medium containing silt sand, the transmitter head needs to take protective measures such as filtering measures to prevent the pressure measuring hole from being clogged or the particle scratching film.
sheet.
5. When using in hazardous environment such as inflammable and explosive, please install safety barrier according to the regulations. The cable connection should be sealed and reliable. Tighten the junction box cover before powering up to ensure that the transmitter cavity is isolated from the environment. When cleaning, repairing or modifying parameters, the power must be completely removed, the transmitter removed, and moved to a safe environment for processing. On-site live operation is strictly prohibited.
6. If the product to be ordered requires a metrological verification certificate or other special requirements, please contact the company and indicate in the order.