

WS3032 Mini ultrasonic wind speed and direction sensor

MAIN FEATURES

- Maintenance-free, long service life
- No moving parts, zero wear
- Engineering plastic or aluminum alloy shell, lighter
- Reflective ultrasonic probe, more compact structure
- Using acoustic wave phase compensation technology, higher accuracy



OVERVIEW

WS3032 anemometer is a kind of measuring instrument which uses the time difference of ultrasonic wave in the air to measure the wind speed and direction. WS3032 uses a low power chip inside, and the power consumption of the whole instrument is only 0.2W, which is especially suitable for the solar or battery powered environment with high power consumption requirements. As a result of adopting new technology and new process, the structure is more compact and compact, the cost is greatly reduced compared with the original WS3032 series anemometer, and the shell has two kinds of metal casting aluminum and ABS, which are convenient for users to use in different environments

It is mainly used in family meteorological station, farmland meteorological detection, tower crane wind speed monitoring, etc.

SPECIFICATION

ITEMS	Principle	Range	Accuracy	Resolution
Wind speed	Ultrasonic	0-40m /s	± 3%	0.1m/s
Wind direction	Ultrasonic	0-359 °	±3 °	1 °
Temperature (optional)	MEMS sensor	- 40 °C - + 80 °C	± 0.5°C	0.1 °C
Humidity (optional)	MEMS sensor	0 – 100%	±5%	1%
Atmospheric pressure (optional)	MEMS sensor	150 – 1100hPa	±1hpa	0.1hPa
Rainfall (optional)	Radar	0-200mm/hr	±5%	0.1mm
Digital output	Digital output: RS232, RS485, SDI-12; analog output (optional): 2-4-20mA			
Power supply	VDC: 5V-30V			
IP protection	IP65			
Operating environment	-30°C - +60°C, 0 - 100%			
Communication	ModBus, NMEA-0183, ASCII			
Size	Φ84×120mm ABS: 0.38kg Aluminum alloy: 0.78kg			
Material	ABS engineering plastics/aluminum alloy			
Power Consumption	0.2W (wind speed, wind direction, temperature and humidity, air pressure) + 1.5W (rainfall)			

DIMENSION & APPLICATION

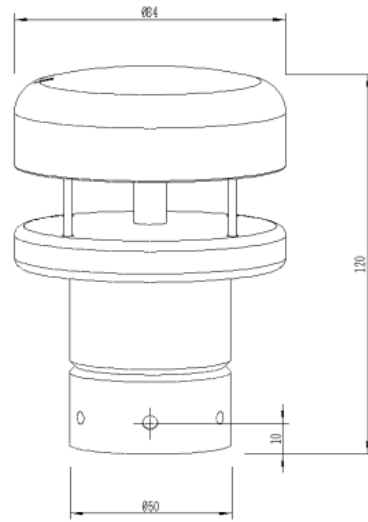
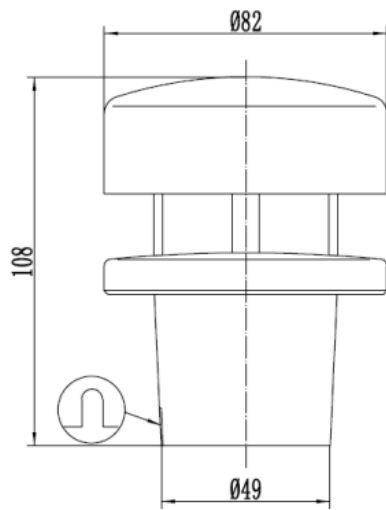

ORDER CODE

Name	Mini Ultrasonic Anemometer		
WS3032	CODE	material	
	A	ABS	
	B	aluminum alloy	
	CODE	Signal output	
	1	RS232	
	2	RS485	
	3	SDI-12	
4	analog output (optional): 2-4-20mA		

INSTALLATION

L type installation

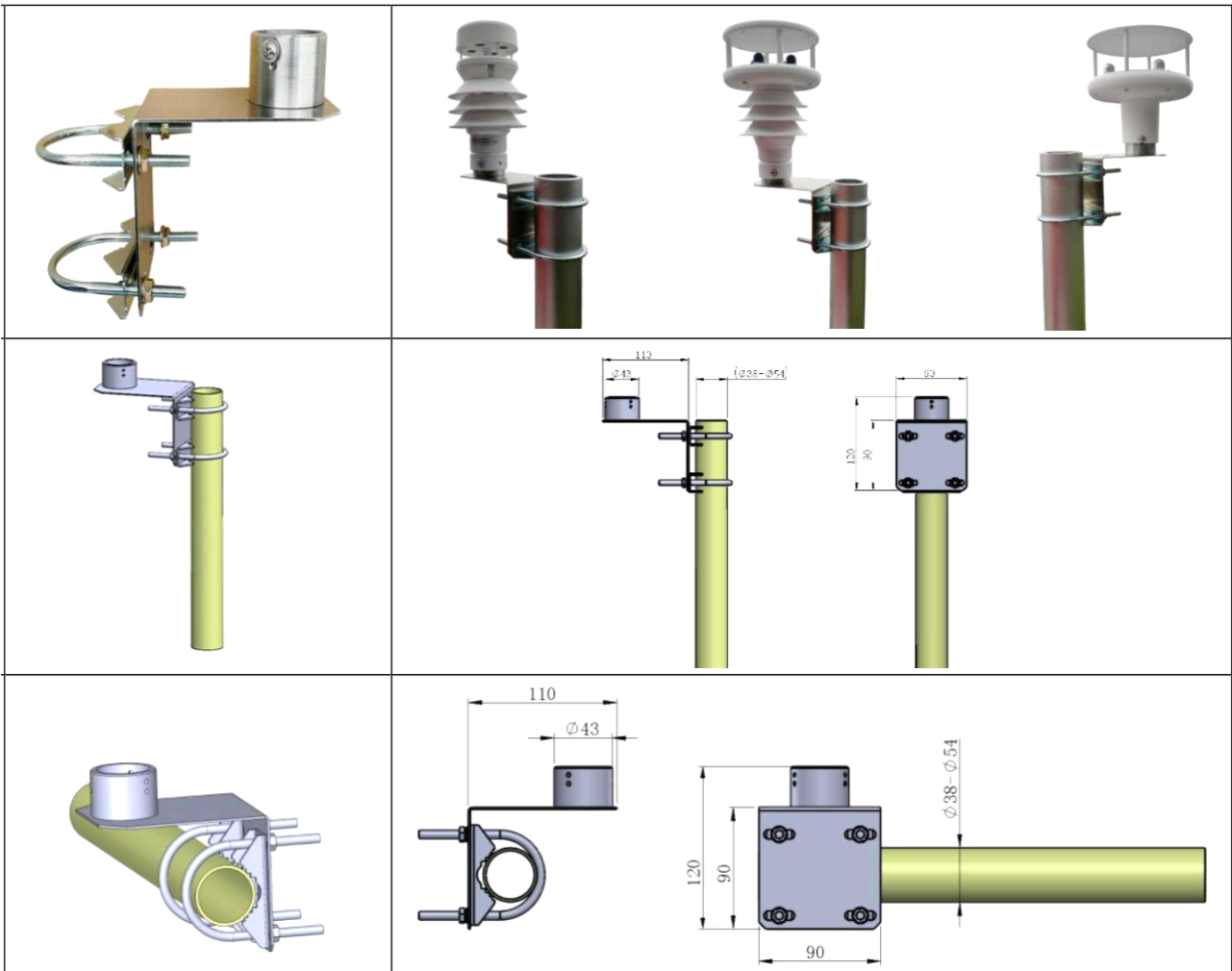

I type installation

