

WS3055 Mini ultrasonic anemometer
OVERVIEW

The WS3055 series wind speed and direction meter uses ultrasonic resonance method to measure wind speed and direction. The WS3055 series is the smallest and lightest ultrasonic anemometer on the market, with a diameter of only 43mm and a weight of only 130g. It uses a low-power chip inside, and the power consumption is only 0.1W when it is low.

This series of ultrasonic anemometers is designed for different usage environments with multiple installation methods and three shell materials to meet the user's personalized use. The shell materials are ABS, aluminum alloy and stainless steel, and the surface is specially treated with oxidation resistance and corrosion resistance.

The installation methods include vertical installation, hoisting and horizontal installation. The protection level can be increased to IP68 to adapt to use in harsh offshore environments.

Mainly used in meteorological stations, high-voltage towers, communication towers, special ventilation ducts, offshore buoys, etc.

SPECIFICATION

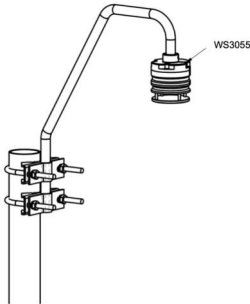
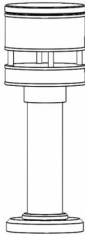
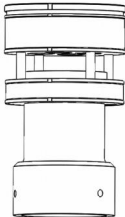
Model	WS3055A Hoisting installation	WS3055B Vertical installation	WS3055C Strong heating
Installation methods			
External dimension / weight	Φ50×60mm / 0.28kg(aluminum alloy)	Φ46×53mm / 0.09kg(aluminum alloy)	Φ56×100mm / 0.2kg
Power supply	DC5-30V		DC5-30V (heating version 12-24VDC)
Power consumption	0.1W(Min)		0.1W(Min)/heating 24W
Operating environment	-40°C- +60°C,0 - 100%		-60°C- +70°C,0 - 100%
Wind speed (Range/ accuracy/resolution)	0 - 60m / S, ±3%, 0.1m/s		
Wind direction (Range/ accuracy/resolution)	0 - 359°/±3°/1°		
Digital output	RS485, SDI-12		
Baud rate	4800-19200		
Communication	Modbus, ASCII, NMEA-0183		
Protection level	IP65(IP68 customized)		
Material/color	Aluminum alloy/black		

DIMENSION

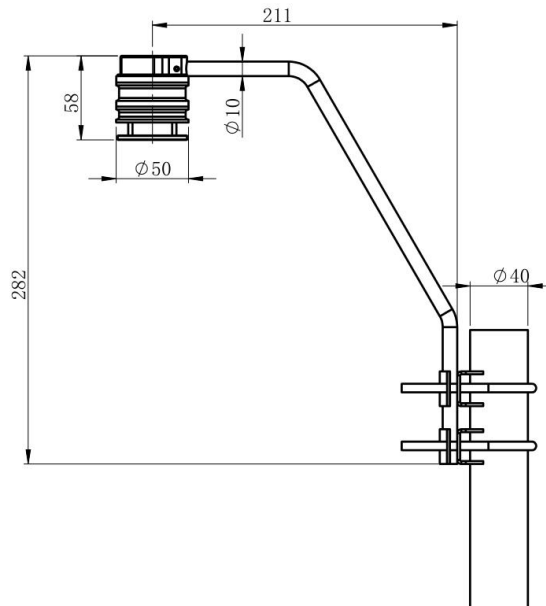

APPLICATION

Mainly used in meteorological stations, high-voltage iron towers, communication iron towers, special ventilation pipelines, offshore buoys, etc.



ORDER CODE

WS3055	Ultrasonic Wind Speed & Direction Sensor			
	CODE	Function type		
	A	Wind speed + wind direction		
		CODE	Signal output	
		1	RS485	
		2	SDI-12	
WS3055	A	1	Order example	