

SEM226HC Piezoelectric Rain Detector

APPLICATION

- Meteorological monitoring
- Coastal rainwater monitoring
- Hydrology and water conservancy monitoring
- Agrometeorological monitoring
- Road safety monitoring
- Energy monitoring
- Commercial water demand monitoring

FEATURES

- Light and sturdy
- Easy to install
- Low power consumption
- Compact design without moving parts
- Maintenance free;



OVERVIEW

SEM226HC piezoelectric rain gauge is a monitoring equipment developed for hydrology and water conservancy industry. It can measure rainfall through a maintenance free piezoelectric principle without moving parts, and can realize 24-hour continuous online monitoring of outdoor rainfall parameters.

SPECIFICATION

Measurement form	piezoelectric
Measuring range	0-200mm/h
Resolution	0.1mm
Sampling frequency	1HZ
Power supply	DC12-24V
Communication	RS485 interface (MODBUS protocol)
Power consumption	< 0.2W
Optional Output	Continuous rainfall, rainfall duration, rainfall intensity, maximum rainfall intensity
Maximum output frequency	Passive mode: 1/S
working temperature	0°C–70°C
Degree of protection	IP65
Fixing method	The standard product is fixed by sleeve, see the product dimension drawing. (Flange fixing or bending plate fixing mode is optional)
Fixing bracket	None for standard products, 1.5m and 1.8m brackets are optional (to be purchased separately)
Cable	3m cable (10m communication cable is optional)
Remarks	Measuring rainfall by piezoelectric principle: measure the size of raindrops by the impact force of falling raindrops on the external surface, and calculate the rainfall. Compared with the traditional non physical tipping bucket rain gauge, the accuracy is its weakness. In most cases, the measured value of the piezoelectric rain gauge will be close to that of the tipping bucket rain gauge, but there will be significant deviation for special cases (short-term heavy rainfall). The arc shaped top cover is designed not to retain rainwater, and can work around the clock without maintenance. Small size, no moving parts, easy installation. It is more suitable for occasions that need to be moved and cannot be maintained.

DIMENSION

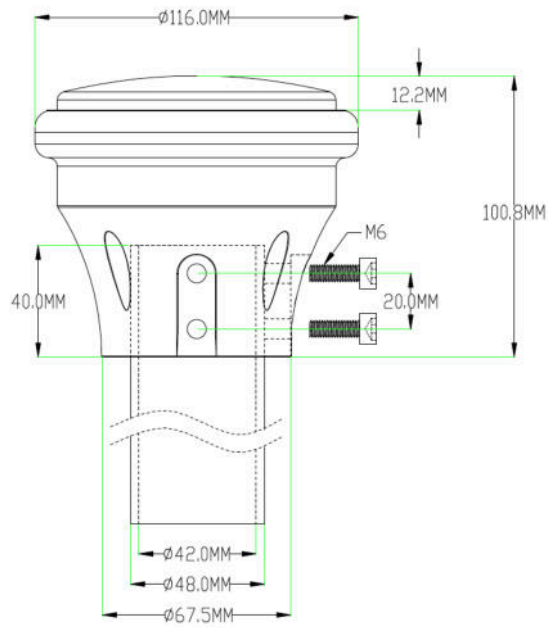

Unit: mm

INSTALLATION

- Fixing method of flange plate:

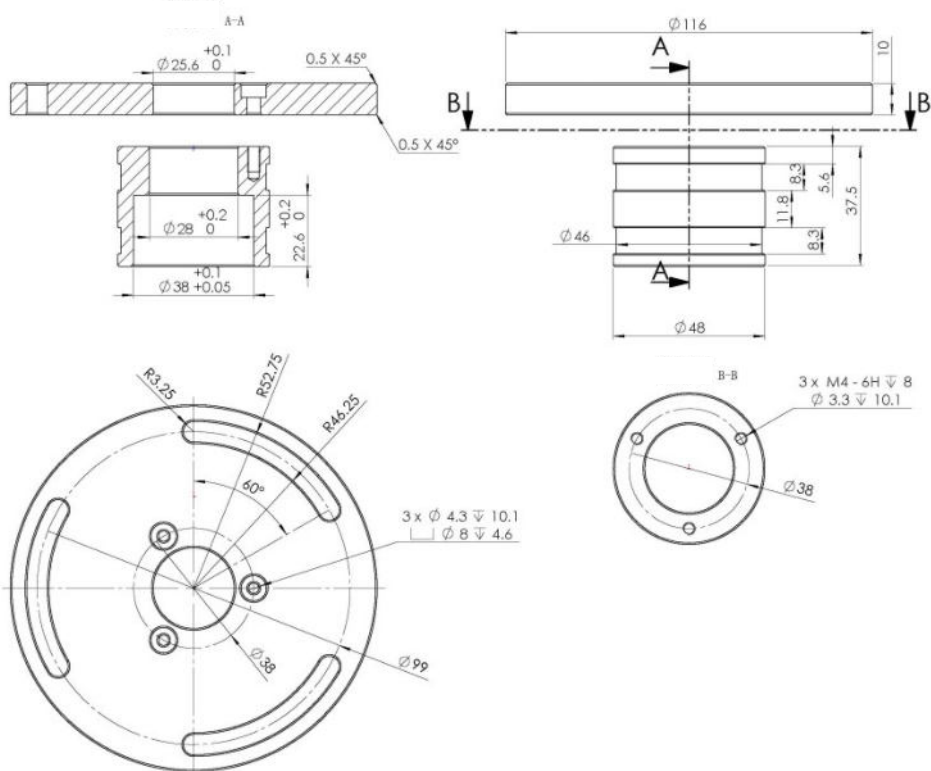

• Fixing method of bending plate:

